

51,742 SQUARE FEET AVAILABLE / DIVISIBLE PROFESSIONAL OFFICE BUILDING

10801 Corporate Drive, Pleasant Prairie, WI - LakeView Corporate Park



- Total Building Size: 10801 Corporate Drive, Pleasant Prairie, WI
- Total Building Size: 51,742 SF / DIVISIBLE
- Available Size:
 - Ground Level 17,855 SF
 - First Floor 18,504 SF
 - Second Floor 15,383 SF
- Site Size: 8.3 Acres
- Zoning: B-5 Freeway Office District
- Power: 1200 A / 480/277 V / 3 Phase
Backup power generator
- Sprinklered: 100% wet sprinkler system, building fully sprinkled
- HVAC: Hot water system with two (2) gas fired boilers.
Five (5) roof top gas fired air conditioning units.
System provides year round A/C to entire building.
- Sale Price: Subject to Offer
- Lease Price: \$14.00 Net per square foot
- High-end corporate headquarters office building
- Located in the Prestigious LakeView Business Park
- 1 Mile north of the Illinois / Wisconsin border
- Low Wisconsin Real Estate Taxes

Whit R. Heitman

Principal

773-714-2138

whitman@painewetzel.com

Sam Badger, SIOR

Senior Vice President

773-714-2099

sbadger@painewetzel.com

Brad Weiner

Vice President

773-714-2098

bweiner@painewetzel.com



51,742 SQUARE FEET AVAILABLE / DIVISIBLE PROFESSIONAL OFFICE BUILDING

10801 Corporate Drive, Pleasant Prairie, WI - LakeView Corporate Park



Whit R. Heitman
Principal
773-714-2138
wheitman@painewetzel.com

Sam Badger, SIOR
Senior Vice President
773-714-2099
sbadger@painewetzel.com

Brad Weiner
Vice President
773-714-2098
bweiner@painewetzel.com



51,742 SQUARE FEET AVAILABLE / DIVISIBLE PROFESSIONAL OFFICE BUILDING

10801 Corporate Drive, Pleasant Prairie, WI - LakeView Corporate Park

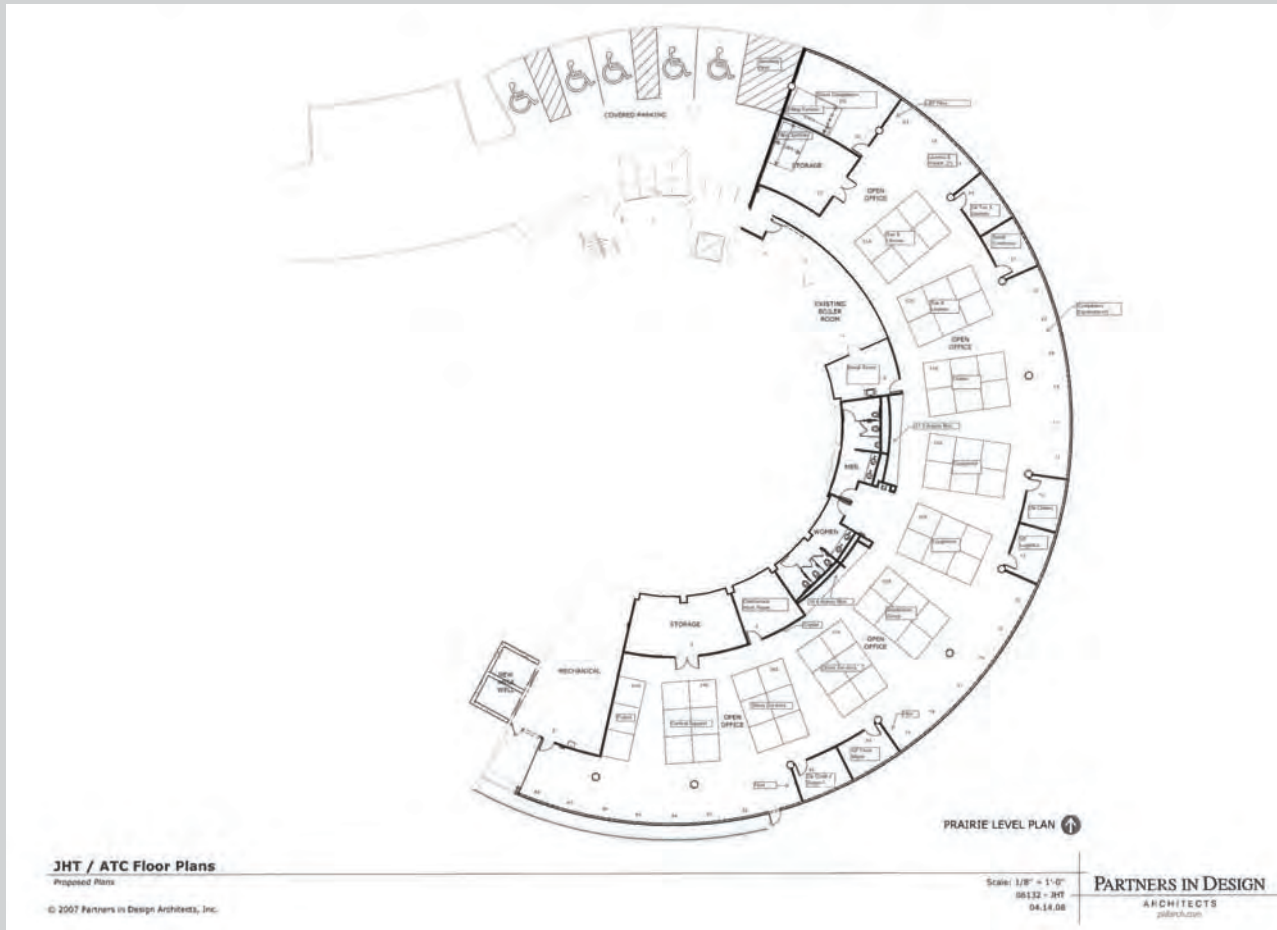

Prairie Level Floor Plan (not to scale)

Whit R. Heitman

Principal

773-714-2138

whitman@painewetzel.com

Sam Badger, SIOR

Senior Vice President

773-714-2099

sbadger@painewetzel.com

Brad Weiner

Vice President

773-714-2098

bweiner@painewetzel.com



51,742 SQUARE FEET AVAILABLE / DIVISIBLE PROFESSIONAL OFFICE BUILDING

10801 Corporate Drive, Pleasant Prairie, WI - LakeView Corporate Park

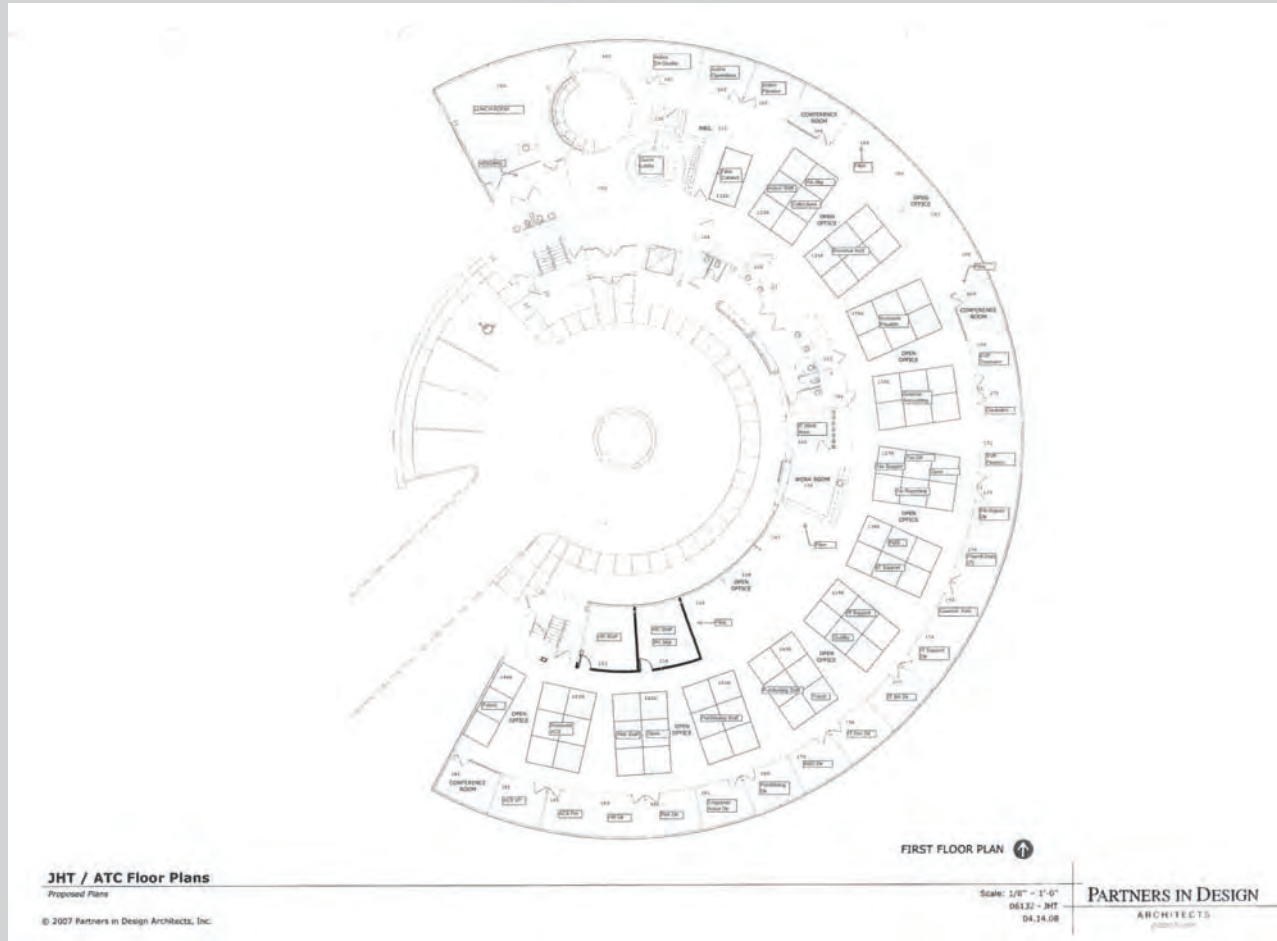

1st Floor - Floor Plan (not to scale)

Whit R. Heitman
Principal
773-714-2138
whitman@painewetzel.com

Sam Badger, SIOR
Senior Vice President
773-714-2099
sbadger@painewetzel.com

Brad Weiner
Vice President
773-714-2098
bweiner@painewetzel.com



51,742 SQUARE FEET AVAILABLE / DIVISIBLE PROFESSIONAL OFFICE BUILDING

10801 Corporate Drive, Pleasant Prairie, WI - LakeView Corporate Park

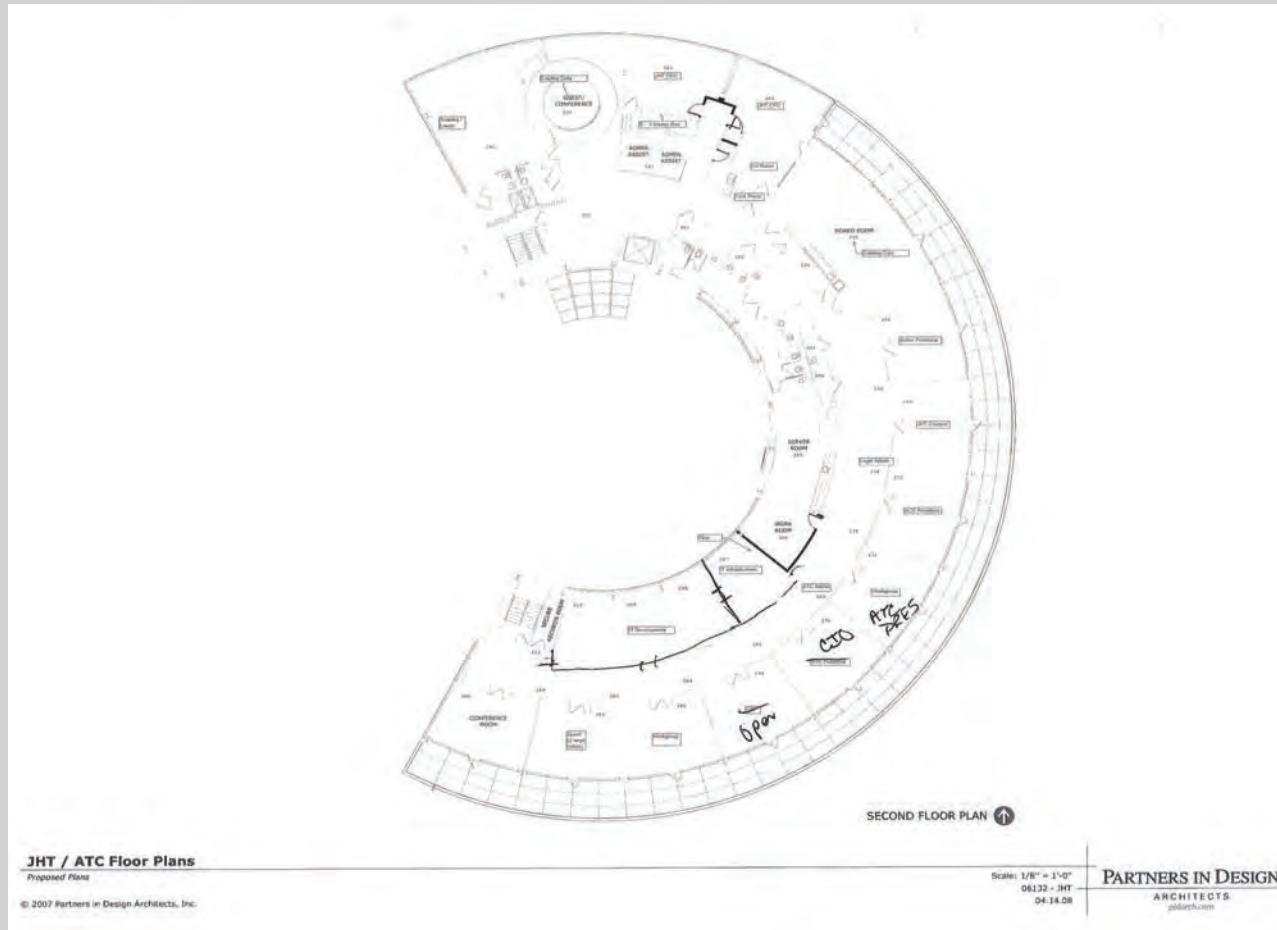

2nd Floor - Floor Plan (not to scale)

Whit R. Heitman
Principal
773-714-2138
whitman@painewetzel.com

Sam Badger, SIOR
Senior Vice President
773-714-2099
sbadger@painewetzel.com

Brad Weiner
Vice President
773-714-2098
bweiner@painewetzel.com



51,742 SQUARE FEET AVAILABLE / DIVISIBLE PROFESSIONAL OFFICE BUILDING

10801 Corporate Drive, Pleasant Prairie, WI - LakeView Corporate Park



Whit R. Heitman
Principal
773-714-2138
wheatman@painewetzel.com

Sam Badger, SIOR
Senior Vice President
773-714-2099
sbadger@painewetzel.com

Brad Weiner
Vice President
773-714-2098
bweiner@painewetzel.com



BROKER DISCLOSURE TO CUSTOMERS

Prior to negotiating on your behalf the Broker must provide you the following disclosure statement:

BROKER DISCLOSURE TO CUSTOMERS

You are a customer of the broker. The broker is either an agent of another party in the transaction or a subagent of another broker who is the agent of another party in the transaction. The broker, or a salesperson acting on behalf of the broker, may provide brokerage services to you. Whenever the broker is providing brokerage services to you, the broker owes you, the customer, the following duties:

- The duty to provide brokerage services to you fairly and honestly.
- The duty to exercise reasonable skill and care in providing brokerage services to you.
- The duty to provide you with accurate information about market conditions within a reasonable time if you request it, unless disclosure of the information is prohibited by law.
- The duty to disclose to you in writing certain material adverse facts about a property, unless disclosure of the information is prohibited by law (**See DEFINITION OF MATERIAL ADVERSE FACTS**).
- The duty to protect your confidentiality. Unless the law requires it, the broker will not disclose your confidential information or the confidential information of other parties (**See CONFIDENTIALITY NOTICE TO CUSTOMERS**).
- The duty to safeguard trust funds and other property the broker holds.
- The duty, when negotiating, to present contract proposals in an objective and unbiased manner and disclose the advantages and disadvantages of the proposals.

Please review this information carefully. A broker or salesperson can answer your questions about brokerage services, but if you need legal advice, tax advice, or a professional home inspection, contact an attorney, tax advisor, or home inspector.

This disclosure is required by Section 452.135 of the Wisconsin statutes and is for information only. It is a plain-language summary of a broker's duties to a customer under section 452.133 (1) of the Wisconsin statutes.

CONFIDENTIALITY NOTICE TO CUSTOMERS

BROKER WILL KEEP CONFIDENTIAL ANY INFORMATION GIVEN TO BROKER IN CONFIDENCE, OR ANY INFORMATION OBTAINED BY BROKER THAT HE OR SHE KNOWS A REASONABLE PERSON WOULD WANT TO BE KEPT CONFIDENTIAL, UNLESS THE INFORMATION MUST BE DISCLOSED BY LAW OR YOU AUTHORIZE THE BROKER TO DISCLOSE PARTICULAR INFORMATION. A BROKER SHALL CONTINUE TO KEEP THE INFORMATION CONFIDENTIAL AFTER BROKER IS NO LONGER PROVIDING BROKERAGE SERVICES TO YOU.

THE FOLLOWING INFORMATION IS REQUIRED TO BE DISCLOSED BY LAW:

1. MATERIAL ADVERSE FACTS, AS DEFINED IN SECTION 452.01 (5g) OF THE WISCONSIN STATUTES (**SEE DEFINITION OF MATERIAL ADVERSE FACTS**).
2. ANY FACTS KNOWN BY THE BROKER THAT CONTRADICT ANY INFORMATION INCLUDED IN A WRITTEN INSPECTION REPORT ON THE PROPERTY OR REAL ESTATE THAT IS THE SUBJECT OF THE TRANSACTION.

TO ENSURE THAT THE BROKER IS AWARE OF WHAT SPECIFIC INFORMATION YOU CONSIDER CONFIDENTIAL, YOU MAY LIST THAT INFORMATION BELOW (**SEE CONFIDENTIAL INFORMATION**). AT A LATER TIME, YOU MAY ALSO PROVIDE THE BROKER WITH OTHER INFORMATION YOU CONSIDER TO BE CONFIDENTIAL.

CONFIDENTIAL INFORMATION: _____

NON-CONFIDENTIAL INFORMATION (The following information may be disclosed by Broker): _____

(INSERT INFORMATION YOU AUTHORIZE THE BROKER TO DISCLOSE SUCH AS FINANCIAL QUALIFICATION INFORMATION)

CONSENT TO TELEPHONE SOLICITATION

I/We agree that the Broker and any affiliated settlement service providers (for example, a mortgage company or title company) may call our/my home or cell phone number regarding issues, goods and services related to the real estate transaction until I/we withdraw this consent in writing.

List Home/Cell Numbers: _____

SEX OFFENDER REGISTRY

Notice: You may obtain information about the sex offender registry and persons registered with the registry by contacting the Wisconsin Department of Corrections on the Internet at: <http://offender.com.state.wi.us/public> or by phone at 877-234-0085.

BY INITIALING AND DATING BELOW I/WE ACKNOWLEDGE RECEIPT OF A COPY OF THIS DISCLOSURE AND THAT _____ and _____ are working

Sales Associate ▲

Sales Associate ▲

As: (Owner's Listing Broker's Agent) (Buyer's/Tenant's Agent or Buyer's Broker's Agent) **STRIKE ONE**

INITIALING THIS FORM TO ACKNOWLEDGE RECEIPT DOES NOT CREATE ANY LEGAL OBLIGATIONS TO BROKER.

Initials ▲

Date ▲

Print Name (optional) ▲

Initials ▲

Date ▲

Print Name (Optional) ▲

No representation is made as to the legal validity of any provision or the adequacy of any provision in any specific transaction.

DEFINITION OF MATERIAL ADVERSE FACTS

A "material adverse fact" is defined in Wis. Stat. § 452.01 (5g) as an adverse fact that a party indicates is of such significance, or that is generally recognized by a competent licensee as being of such significance to a reasonable party, that it affects or would affect the party's decision to enter into a contract or agreement concerning a transaction or affects or would affect the party's decision that a competent licensee generally recognizes will significantly and adversely affect the value of the property, significantly reduce the structural integrity of improvements to real estate, or present a significant health risk to occupants of the property, or information that indicates that a party to a transaction is not able to or does not intend to meet his or her obligations under a contract or agreement made concerning the transaction.